

# OA1000 Pro Series

Multimedia Fingerprint & RFID Terminal



OA1000 Mercury Pro

OA1000 Pro

OA1000 URU Pro



Linux



Dual-core  
1.0GHz CPU



Cloud  
Management



Realtime  
Snapshot



WiFi  
(Optional)



3G  
(Optional)

As a flagship series of Anviz high level fingerprint access control, OA1000 Pro series meet various integration requirements with Dual Core 1.0GHz CPU and inbuilt cloud software. Based on Linux platform, integrated with third party modules like HID iClass RFID module, live scan Lumidigm sensor, and 360°identification U.are.U sensor. OA1000 Pro series is the most favorite choice for professional security system integrators.



## Model Line

Mode	OA1000 Pro	OA1000 Mercury Pro (Live Identification)		OA1000 URU Pro (360° Identification)	
Sensor	AFOS	Lumidigm		URU	
Algorithm	Anviz BioNANO	Lumidigm	Anviz BioNANO (Optional)	U.ARE.U	Anviz BioNANO (Optional)
User Capacity	10,000	1,000	10,000	1,000	10,000
Fingerprint Template Capacity	10,000	1,000 30,000(1:1)	10,000	1,000 30,000(1:1)	10,000
Scan Area(W * H)	18mm * 22mm	13.9mm * 17.4mm		14.6mm * 18.1mm	
Dimensions(W * H * D)	180 * 137 * 40mm	180 * 137 * 50mm		180 * 137 * 40mm	

## Specification

Item	Description
Resolution	500 DPI
FRR	0.001%
FAR	0.00001%
LCD	3.5 Inch TFT Display
Camera	1.3 Million Pixel Camera
Log Capacity	200,000
User Photo Capacity	500 Support 32G SD card
Support RFID Card	Standard 125KHZ EM ,Optional13.56MHZ Mifare , HID iClass
Identification Mode	FP, Card, ID+FP, ID+PW, PW+Card, FP+Card
Identification Time	1: 10,000 <0.5 Sec
Communication Interface	TCP/IP, RS232, USB Flash Drive Host, Optional WIFI, 3G
Webserver	Built-in Webserver
Built-in Relay	2 Relays Output (Directly Lock control & Alarm output)
I/O	Wiegand In&Out, Switch, Door Bell
Image Display	User Photo & Fingerprint Image
Short Message	50
Scheduled Bell	30 Scheduleds
Self-service Record Inquiry	Yes
Groups & Time Schedules	16 Groups, 32 Time Zones
Certificate	FCC, CE, ROHS
Tamper Alarms	Yes
Operating Voltage	DC 12V
Temperature	-20 C ~ 60 C
Preferred Humidity	10 to 90%
Firmware Update	USB Flash Drive, TCP/IP, Webserver

## Features

- Dual Core high speed CPU, large memory support 10,000 FP Templates
- Less than 0.5s rapidly verification speed (1:10,000)
- 1.3 Million Camera capture verifier's photo for event backup
- Built-in Webserver for device quick set and records check
- TCP/IP, WIFI, 3G and RS485 multi communication modes
- Dual Relays both for door control and linkage with alarm system
- Provide complete Development Kit to build exclusive application platform(SDK, EDK, SOAP)
- Supports a variety of third-party modules, to meet different project requirement(Mercury, U.ARE.U, HID iClass)

## Outline Drawing

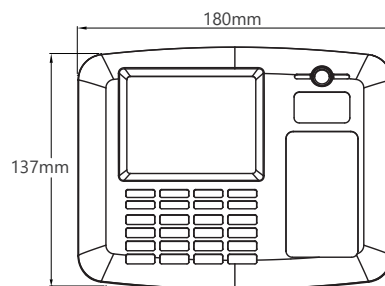

Front view

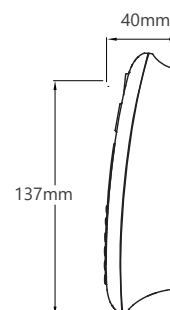

Side view

## Finger Sensor

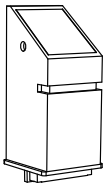

**AFOS**

Waterproof  
Dust proof  
Scratchproof

**AFOS**

The high quality optical imaging glass results in improved image. Antireflective and wear resistant plate enhances the durability. The fully sealed sensor offers the weather resistance and durability.

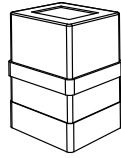

**Lumidigm**

Wet Fingerprint  
Dirty Fingerprint  
Oil Fingerprint

**Lumidigm**

The Lumidigm fingerprint sensor adopts multispectral imaging technology is that it virtually eliminates common real world problems experienced by conventional fingerprint sensors.

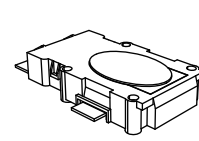

**digitalPersona**



**URU**

The digital Person fingerprint sensor utilizes optical fingerprint scanning technology for superior image quality and product reliability.



# CrossChex Cloud

For Global Cloud System  
Time Attendance and Access Control Management System

## Advantages

- No need to install, maintain, or upgrade software
- No expensive computers to purchase or maintain
- Access data in real-time from any PC and Mobile with Internet
- Receive real-time alerts to your email
- Multiple encryptions and redundancy backup for data safety.

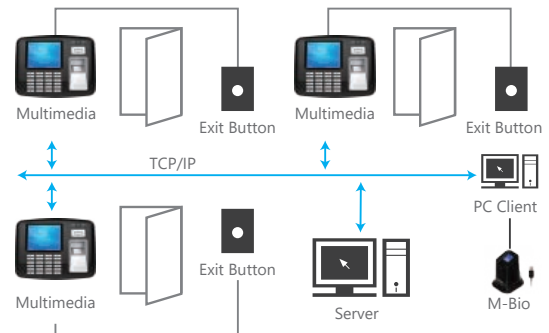

CrossChex Cloud

Multimedia

Multi-Platform



Please scan this QR code to get CrossChex Cloud App

# About Anviz

Founded in 2001, Anviz is a global leader in the field of intelligent security including Biometric and RFID. Cutting edge technologies, sophisticate QA system (ISO certified) and worry-free services & support provide our partners with the key of business success.

Anviz dedicates to offer professional and comprehensive security solutions. With the continuously growing demand of public and private security, Anviz announced the surveillance product line which was created based on the innovations of our optical and digital image processing technology.

Combining the high-quality products and cost-effective security solutions, Anviz serves various clients from government, law, retail, industrial, commercial, financial, medical, education, etc.

## AGPP Anviz Global Partner Program

AGPP is Anviz Global Partner Program. It is designed for industry-leading distributors, resellers, software developers and system integrators highly qualified in providing intelligent security solutions of Biometric, RFID and Surveillance in targeted vertical markets. The program helps partners build a sustainable business model in a fast-changing environment, where customers require value-added services, focused technical expertise and high levels of satisfaction.



**Aggressive**  
Industry-leading Margins

**Priority**  
Partner Technical Support

**Online**  
Ordering and Private Partner Portal

**Assisted**  
Marketing Campaign Programs

**Preferred**  
Professional Services

**Earned**  
MDF CO-OP Funds

### Warranty

The Anviz Products, enclosed with this Limited Hardware Warranty will in respect of the hardware be free from defects in design, workmanship and materials under normal use for a period of 1, 2 or 3 years from the date of the original purchase ("Warranty Period").

For more Anviz Warranty Service, please visit:



### Support

Anviz Technical Support provides efficient assistance for your products. With online support services [www.anviz.com/support](http://www.anviz.com/support) and Anviz Service One App you can rest assured that you'll receive assistance wherever you are, whenever you need it.

#### Service One

"Service One" is an application in APP store include in all Anviz technology support and products information:

- 7x24-hour online self service
- Submit any needs and questions anywhere and anytime

Service One



For more information, visit [www.anviz.com](http://www.anviz.com), or email us [sales@anviz.com](mailto:sales@anviz.com).

2017© Anviz Global. All Rights Reserved. Due to the consistent improving of the product, this specification and appearance is subject to change without notice.